

UNC ASHEVILLE POLLINATOR MEADOW

SUPPORTED BY

**BURT'S BEES GREATER GOOD FOUNDATION &
THE BLUE RIDGE NATIONAL HERITAGE AREA PARTNERSHIP**

THESE WILDFLOWERS AND GRASSES ARE SELECTED FOR SUMMER-LONG FLOWERING, DROUGHT TOLERANCE, DISEASE RESISTENCE, UNIFORMITY OF HEIGHT (UNDER 36"), AND CULTURAL COMBATABILITY. SPECIES ARE GROUPED IN DRIFTS, WHICH INSECTS PREFER.

LOCAL PLANT SPECIES ARE BETTER POLLEN SOURCES. PLANT CULTIVARS ARE USED HERE FOR ORNAMENTAL APPEAL AND INSECT FOOD SOURCE EVALUATION. SOME CULTIVARS ARE BETTER POLLEN PRODUCERS THAN OTHERS. THE GRASSES STABILIZE THE MEADOW AND SUPPLY HABITAT SUPPORT TO INSECTS AND BIRDS.

THE SITE FOR THIS BED IS A SUNNY SOUTH-FACING HILLSIDE WITH WELL-DRAINED SOIL. THE TURF GRASS WAS SPRAYED WITH GLYPHOSATE THE FALL BEFORE PLANTS WERE TO BE INSTALLED. (PLASTIC SHEETING CAN ALSO BE USED TO SOLARIZE EXISTING/ UNWANTED PLANTS.)

THESE PLANTS PREFER POOR SOILS, SO NO SOIL AMENDMENTS ARE NEEDED.

A NUMBERED GRID CAN BE SPRAYED ON THE GROUND FOR LOCATING EACH PLANT.

THE SPACING OF PLANTS IS A UNIFORM 18" ON CENTER, WHICH EQUALS 2.25 SF PER PLANT. THE TOTAL NUMBER OF PLANTS IS FOUND BY DIVIDING THE AREA OF THE BED BY 2.25. WELL ROOTED PLANT PLUGS CAN PRODUCE A GOOD SHOW IN THE FIRST YEAR.

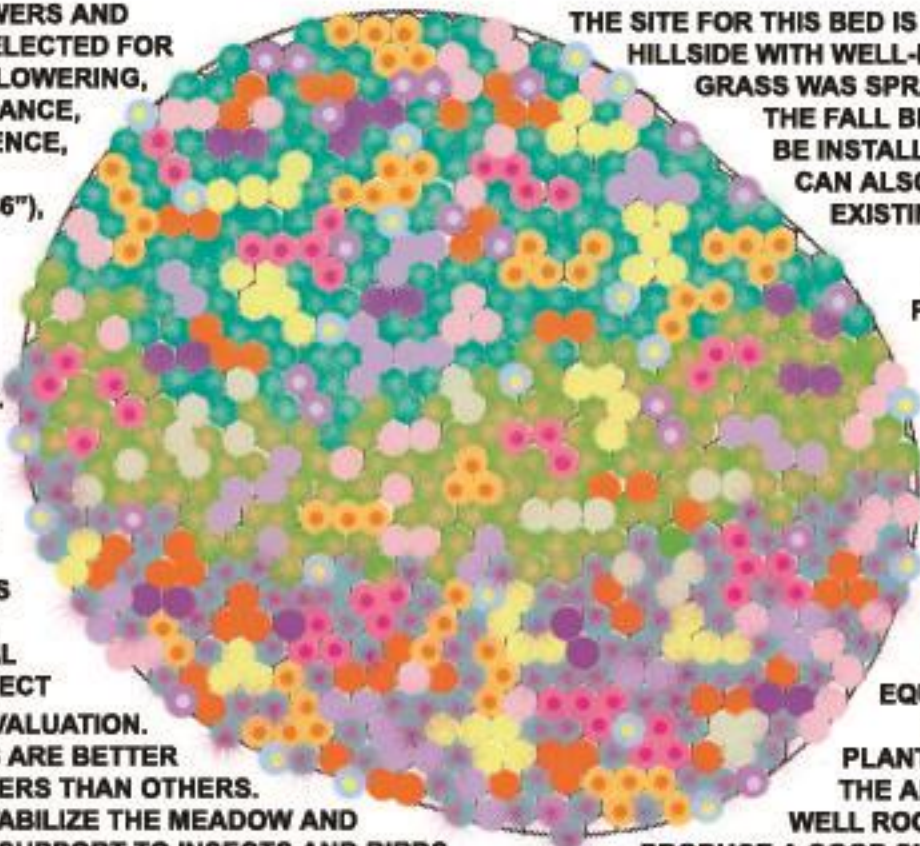

DRY MEADOW PLANT KEY

1,525 SF BED SIZE / 2.25 PLANTS PER SF = 680 PLANTS TOTAL

WILDFLOWERS - 340 PLANTS (ONE HALF OF THE PLANT TOTAL)

SYMBOL QNTY PLANT

- | | | | |
|----|---|----|--|
| 1 | ● | 50 | ASCLEPIAS TUBEROSA - BUTTERFLY WEED |
| 2 | ● | 40 | COREOPSIS VERTICILLATA 'MOONBEAM' - THREADLEAF COREOPSIS |
| 3 | ● | 40 | ECHINACEA PURPUREA 'RUBY STAR' - PURPLE CONEFLOWER |
| 4 | ● | 50 | HELENIUM FLEXUOSUM 'TINY DANCER' - SNEEZEWEED |
| 5 | ● | 20 | LIATRIS SPICATA (SPECIES) - BLAZING STAR |
| 6 | ● | 40 | MONARDA FISTULOSA 'CLAIRE GRACE' - WILD BERGAMOT |
| 7 | ● | 20 | PENSTEMON DIGITALIS - WHITE BEARDTONGUE |
| 8 | ● | 40 | PENSTAMON SMALLII - PINK BEARDTONGUE |
| 9 | ● | 20 | PHLOX PILOSA - PHLOX |
| 10 | ● | 20 | SYMPHYOTRICHUM OBLONGIFOLIUM 'OCTOBER SKY' - ASTER |

GRASSES - 340 PLANTS (ONE HALF ARE GRASSES, FOR STABILITY.)

- | | | | |
|----|---|-----|--|
| 11 | ● | 120 | ANDROPOGON TERNARIUS (LOCAL SPECIES) - SPLIT-BEARD BLUESTEM |
| 12 | ● | 120 | SCHIZACHYRIUM SCOPARIUM (SPECIES) - LITTLE BLUESTEM |
| 13 | ● | 100 | SCHIZACHYRIUM SCOPARIUM 'STANDING OVATION' - LITTLE BLUESTEM |

UNC ASHEVILLE POLLINATOR MOIST MEADOW

SUPPORTED BY

BURT'S BEES GREATER GOOD FOUNDATION &
THE BLUE RIDGE NATIONAL HERITAGE AREA
PARTNERSHIP

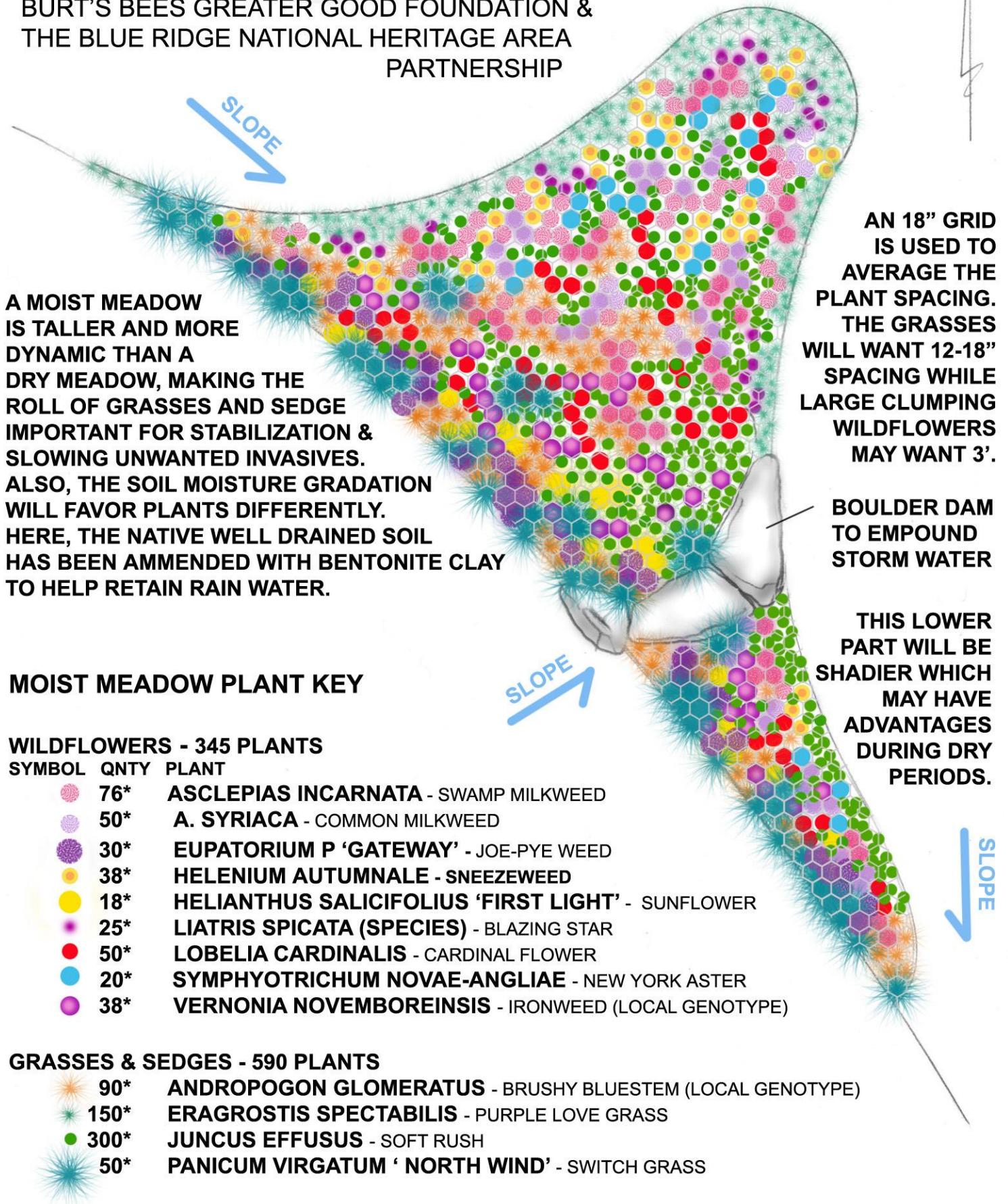

A MOIST MEADOW IS TALLER AND MORE DYNAMIC THAN A DRY MEADOW, MAKING THE ROLL OF GRASSES AND SEDGE IMPORTANT FOR STABILIZATION & SLOWING UNWANTED INVASIVES. ALSO, THE SOIL MOISTURE GRADATION WILL FAVOR PLANTS DIFFERENTLY. HERE, THE NATIVE WELL DRAINED SOIL HAS BEEN AMMENDED WITH BENTONITE CLAY TO HELP RETAIN RAIN WATER.

AN 18" GRID IS USED TO AVERAGE THE PLANT SPACING. THE GRASSES WILL WANT 12-18" SPACING WHILE LARGE CLUMPING WILDFLOWERS MAY WANT 3'.

BOULDER DAM TO EMPOUND STORM WATER

THIS LOWER PART WILL BE SHADIER WHICH MAY HAVE ADVANTAGES DURING DRY PERIODS.





MOIST MEADOW PLANT KEY

WILDFLOWERS - 345 PLANTS

SYMBOL QNTY PLANT

-  76* **ASCLEPIAS INCARNATA** - SWAMP MILKWEED
-  50* **A. SYRIACA** - COMMON MILKWEED
-  30* **EUPATORIUM P 'GATEWAY'** - JOE-PYE WEED
-  38* **HELENIUM AUTUMNALE** - SNEEZEWEED
-  18* **HELIANTHUS SALICIFOLIUS 'FIRST LIGHT'** - SUNFLOWER
-  25* **LIATRIS SPICATA (SPECIES)** - BLAZING STAR
-  50* **LOBELIA CARDINALIS** - CARDINAL FLOWER
-  20* **SYMPHYOTRICHUM NOVAE-ANGLIAE** - NEW YORK ASTER
-  38* **VERNONIA NOVEMBOREINSIS** - IRONWEED (LOCAL GENOTYPE)

GRASSES & SEDGES - 590 PLANTS

-  90* **ANDROPOGON GLOMERATUS** - BRUSHY BLUESTEM (LOCAL GENOTYPE)
-  150* **ERAGROSTIS SPECTABILIS** - PURPLE LOVE GRASS
-  300* **JUNCUS EFFUSUS** - SOFT RUSH
-  50* **PANICUM VIRGATUM 'NORTH WIND'** - SWITCH GRASS